

# Subplates D03 (Size 6) Bottom-Ported

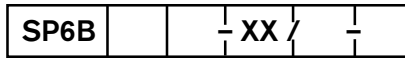

**Flow**  
Normal  
High  
Extra High  
High Pressure  
**Revision**

= N  
= H  
= X  
= H  
= XX

12 =  
05 =  
01 =

**Ports**  
SAE Threaded Ports  
NPT Threaded Ports  
BSP Threaded Ports

**Material**  
Aluminum 6061-T6, 3000 psi  
Ductile Iron<sup>1</sup> 65-45-12, 5000 psi

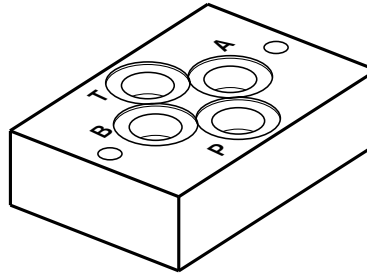
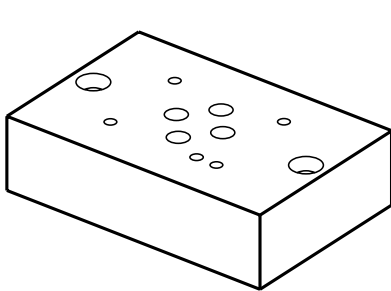
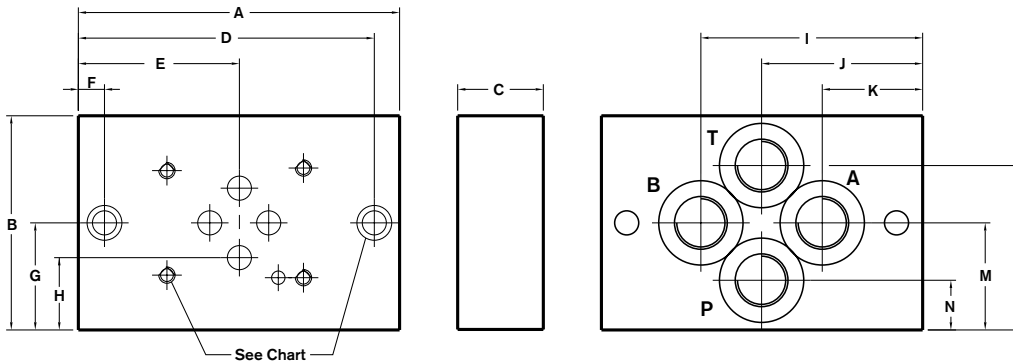

Port type	Approx. Weight	
	Alum	Duct
SP6BN-1X/...	0.9	2.4
SP6BH-1X/...	1.4	3.7
SP6BX-1X/...	2.7	7.2
SP6BNH-1X/...	-	2.4

Port type	P,T & A,B Ports			Mounting Bolts			Valve Mtg.	
	12	05	01	12	05	01	05&12	01
SP6BN-1X/...	9/16-18 SAE-6	NPT 1/4"	G (BSP) 1/4"	1/4-20 x 0.75 LG SHCS	1/4-20 x 0.75 LG SHCS	M6-1.0 x (20) LG SHCS		
SP6BH-1X/...	3/4-16 SAE-8	NPT 3/8"	G (BSP) 3/8"	1/4-20 x 0.75 LG SHCS	1/4-20 x 0.75 LG SHCS	M6-1.0 x (20) LG SHCS	10-24 x 0.50 DP	M5-0.8 x (12.7) DP
SP6BX-1X/...	7/8-14 SAE-10	NPT 1/2"	G (BSP) 1/2"	1/4-20 x 0.75 LG SHCS	1/4-20 x 0.75 LG SHCS	M6-1.0 x (20) LG SHCS		
SP6BNH-1X/...	-	NPT 1/4"	-	-	1/4-20 x 0.75 LG	-	1/4-20 x 0.50 DP	-

Dimension	A	B	C	D	E	F	G	H	I	J	K	L	M	N
SP6BN...	3.75	2.50	1.00	3.46	1.88	0.31	1.25	1.66	2.59	1.88	1.17	1.92	1.25	0.58
SP6BH...	4.00	3.00	1.19	3.77	2.00	0.22	1.50	1.91	2.94	2.00	1.05	2.17	1.50	0.83
SP6BX...	5.00	4.00	1.38	4.67	2.50	0.34	2.00	2.41	3.58	2.50	1.42	3.14	2.00	0.86

All dimensions in inches